

# MHS-100G

100W Spot-Wash LED Moving Head  
with GOBOs

Item ref: 150.457UK

User Manual

Please read through this manual thoroughly before use, any damage caused by misuse of product will not be covered by warranty.

A small and lightweight mini moving head that combines 1x 30W white LED with 6x 8W RGBW LED's for the very best in effects and colour mixing. Featuring colourful washes, spots and GOBOs and auto or sound-to-light modes, this 14 channel DMX light effect can be free standing or mounted to trussing using the supplied brackets. Ideal for small stages, bars, nightclubs and mobile DJs the QTX MH-100 provides dazzling performance in a compact, portable unit.



## In the box:

Your MHS-100G should arrive with you in a single carton in good condition. The carton should contain 1 x main unit with bracket, 1 x UK IEC mains lead and 1 x manual.

## Warning:

To prevent risk of fire or electric shock, do not expose the unit to rain or damp environments. In the event of a spillage, disconnect the mains and allow the unit to dry out naturally. Qualified personnel should then check the unit before continuing use.



**Please do not open cover, contains high voltage. This product is not serviceable or repairable by the end user. Please refer to qualified personnel for service and repair.**



## Placement:

- Use the included mounting bracket to fix to a stand or lighting truss.
- Use secondary safety fixings if mounting overhead.
- Keep away from damp or dusty environments.
- Ensure adequate airflow around the fixture housings.
- Ensure adequate access to controls and connections.
- Do not aim LED output directly into line of sight, as this can result in eye injury.

## Cleaning:

- Use a soft cloth with a neutral detergent to clean the casing as required.
- Use a vacuum cleaner to clear ventilation grilles of any dust or debris build-ups.
- Do not use strong solvents for cleaning the unit.

## Rear panel and control

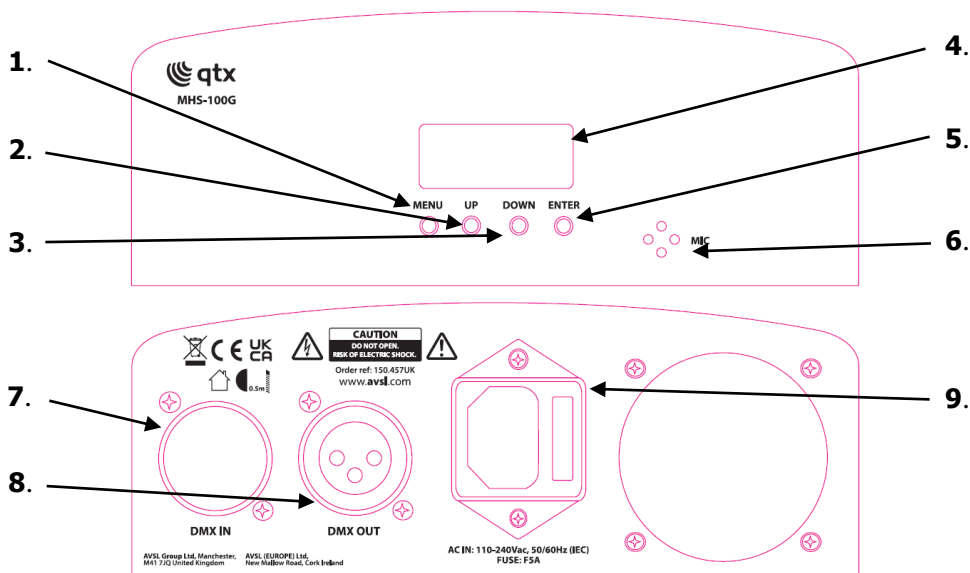

- 1. Menu button**
- 2. Up button**
- 3. Down button**
- 4. LED display**
- 5. Enter button**

- 6. Microphone**
- 7. DMX input**
- 8. DMX output**
- 9. IEC input (110-240 Vac, 50/60 Hz)**

## Manual control menu:

Press the **"MENU"** button to enter the settings menu.  
 Press **"UP"** and **"DOWN"** buttons to navigate through various setting functions.  
 Press **"ENTER"** button to confirm the desired setting.

Menu	Function	Description
Addr	A001 - A512	DMX address settings
rPan	Yes/NO	Pan reverse
rtil	Yes/NO	Tilt reverse
Autx	Aut0 – Aut4	Auto effect modes
	SP00 - SP99	Auto effect speed - slow to fast
SoUn	SoU1 – SoU4	Sound active modes
	SU1 - SU99	Sound active mode sensitivity – low to high
rset	RESET	Reset unit to factory settings

## DMX mode:

The MHS-100G can be controlled by DMX signal, simply connect the DMX signal source to the DMX input on the unit via a balanced XLR lead. Extra fixtures can be controlled by the same DMX signal by looping through the DMX out on the unit. To enter DMX mode, select A001 from the menu and confirm the correct start address by using the **"UP"** and **"DOWN"** buttons and **"ENTER"**. The A on the LED display will begin to flash once it's received the DMX signal from the controller. This unit has 14 DMX channels as indicated in the table below:

Channel	Function	DMX value and description
1	PAN	0-255 PAN adjust 0-540°
2	Tilt	0-255 Tilt adjust 0-270°
3	Pan/Tilt fine	0-255 Pan/Tilt fine adjust
4	RGBW dimmer	0-255 (0-100%)
5	40W White dimmer	0-255 (0.100%)
6	40W White strobe	0-255 (slow to fast)
7	Colour	0-015 White, 016-023 Colour 1, 024-031 Colour 2, 032-039 Colour 3 continued until 120-127 Colour 14, 128-189 Forward rotate (slow to fast), 190-193 Stop, 194-255 Reverse rotate (slow to fast)
8	GOBOs	0-015 White, 016-031 Gobo1, 032-047 Gobo2 continued until 112-127 Gobo7, 128-189 Forward rotate (slow to fast), 190-193 Stop, 194-255 Reverse rotate (slow to fast)
9	Red wash	0-255 (0-100%)
10	Green wash	0-255 (0-100%)
11	Blue wash	0-255 (0-100%)
12	White wash	0-255 (0-100%)
13	Wash strobe	000 No strobe, 001-255 slow to fast
14	Special	0-199 No function, 200-209 Reset, 210-239 No function, 240-255 Sound active mode

## Specifications:

<b>Power supply</b>	110-240Vac, 50/60Hz (IEC)
<b>Power consumption</b>	100W
<b>Fuse rating</b>	F5A
<b>LED power</b>	1x 30W White, 6x 8W RGBW
<b>Modes</b>	Auto, sound, master/slave, DMX512
<b>DMX channels</b>	14CH
<b>PAN range</b>	540°
<b>Tilt range</b>	270°
<b>Effects</b>	RGBW spot, wash, 7x gobos, strobe effect
<b>Dimensions</b>	150 x 160 x 240mm
<b>Weight</b>	2.126kg

## Troubleshooting:

No power (mains)	Check mains voltage is correct and outlet is switched on
	Check IEC lead and fuse (if fuse continually blows, refer to your dealer)
No light output	Check control panel mode settings
	Check DMX settings from controller (dimmer levels, blackout etc.)
Unresponsive to DMX	Check that unit is in DMX mode and ensure the A on the DMX address flashes to confirm it's receiving a DMX signal
	Check DMX controller is not set to blackout
	Check DMX controller is on correct fixture/page
	Check master dimmer value
	Check correct DMX address is set
Overheating/ cutting out	Check DMX connection and leads
	Ensure adequate ventilation and unit is not too close to a heat source



This product is classed as Electrical or Electronic equipment and should not be disposed with other household or commercial waste at the end of its useful life. The goods must be disposed of according to your local council guidelines.

### Errors and omissions excepted.

Copyright© 2022 AVSL Group Ltd, Unit 2 Bridgewater Park,  
Taylor Road, Trafford Park, Manchester. M41 7JQ.

AVSL (Europe) Ltd, Unit 3D North Point House,  
North Point Bus. Park, New Mallow Road, Cork, Ireland.